

Technical drawing of the GracePort interface, showing front and rear views with dimensions.

Front View:

- Top dimension: 8.28 [210.2]
- Bottom dimension: 0.45 [11.4]
- Labels on the front panel:
 - GracePort™ interface
 - P-0100-4-10000
 - 100Watt 20A
 - MOBILE CONFIGURATION OUTLET
 - USB
 - ETHERNET
 - GracePort
 - CE

Rear View:

- Shows the internal components and the rear panel with mounting holes.

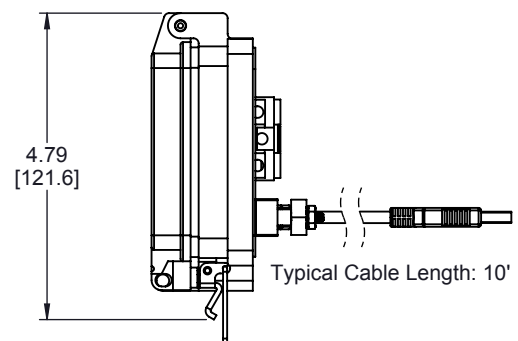
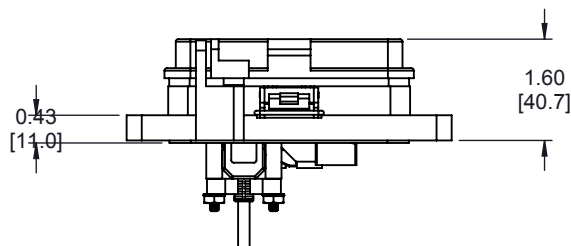
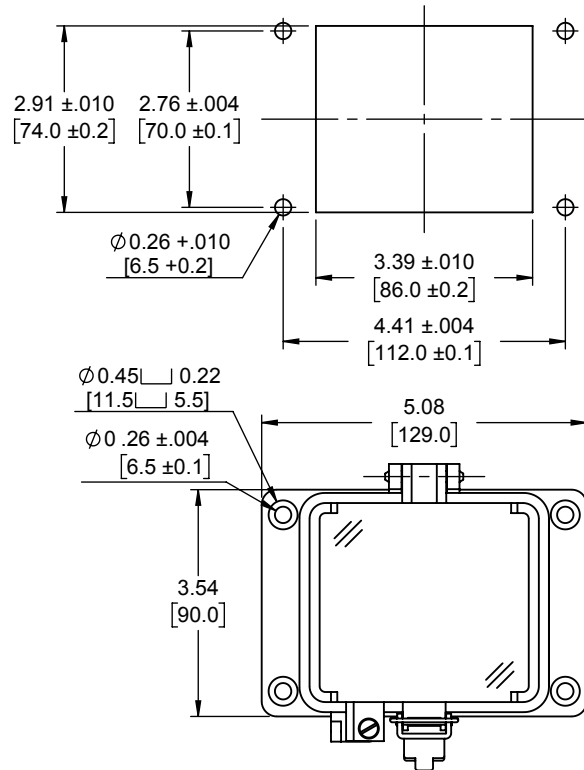

1515 East Kimberly Road - Davenport, IA - www.graceport.com - 1.800.280.9517