

PANEL CUTOUT

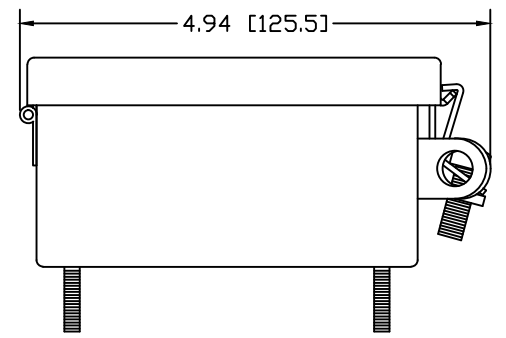
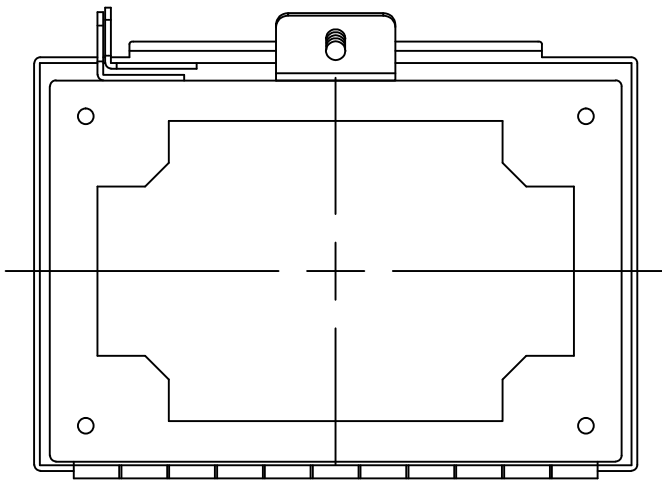
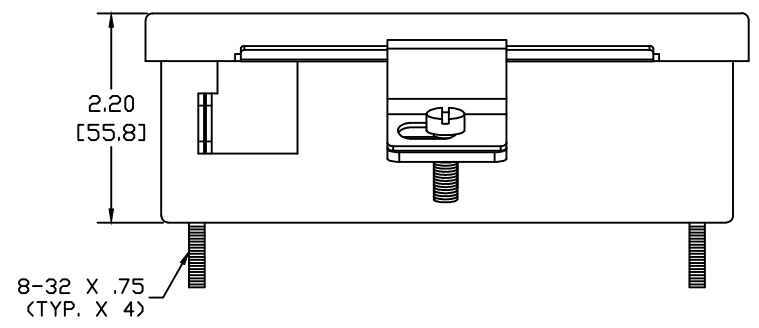
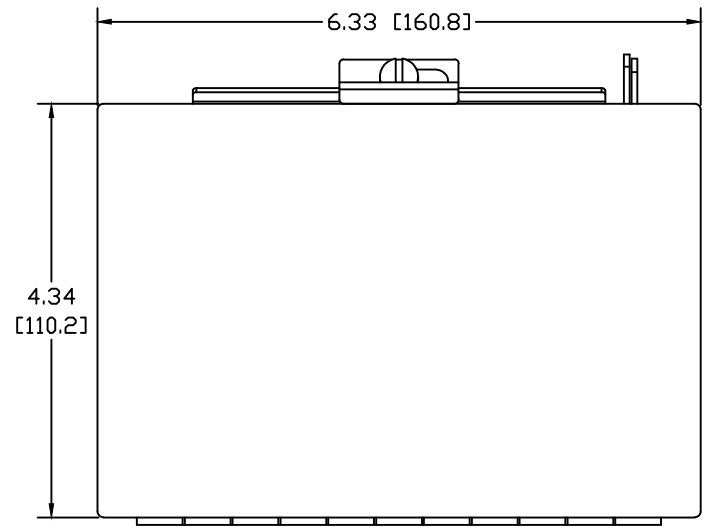
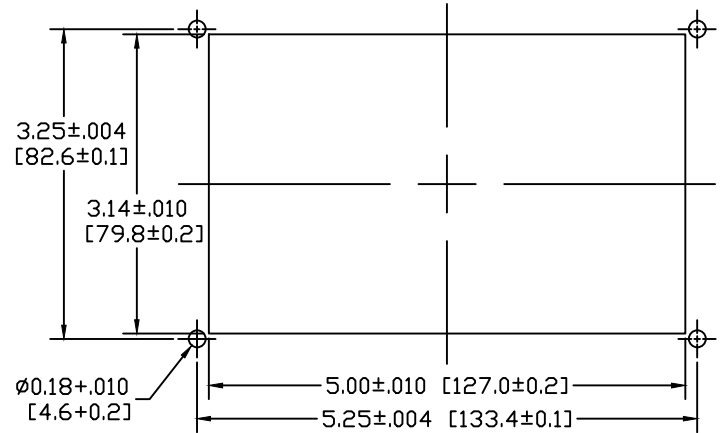

NOTE:
 1.) HOUSING INSERTS COMPONENT LOCATIONS ARE APPROXIMATE.
 2.) HOUSINGS ARE UL RECOGNIZED TYPE 4X OTHER ENVIRONMENTAL RATINGS MAY APPLY.
 3.) FINAL ASSEMBLIES: UL RECOGNIZED, CSA, AND CE MAY APPLY CONSULT FACTORY.
 4.) HOUSING: 16 GA. 316 STAINLESS STEEL HOUSING
 GracePort(R) is a Registered Trademark of Grace Engineered Products, Inc.
 Property of Grace Engineered Products, Inc.